

# THE GATEWAY SALT LAKE CITY

NWC 200 S & N 400 W

Salt Lake City • Utah



## PROJECT FEATURES

- 623,205 gross leasable square feet
- Anchored by Clark Planetarium, Barnes & Noble, Victoria's Secret, Larry H. Miller Megaplex, and Discovery Gateway Children's Museum
- Located directly across from Vivint Smart Home Arena, Home of the Utah Jazz professional basketball team (seats 20,000)
- Salt Lake City is the #1 U.S. market for millennials

## AREA FEATURES

- 84,787 population within a 5-mile radius
- \$59,770 average household income within trade area
- Average age: 29.2 years

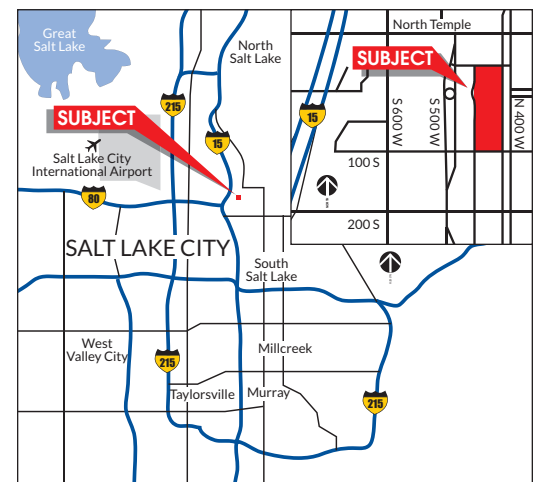

# THE GATEWAY SALT LAKE CITY

NWC 200 S & N 400 W

Salt Lake City • Utah

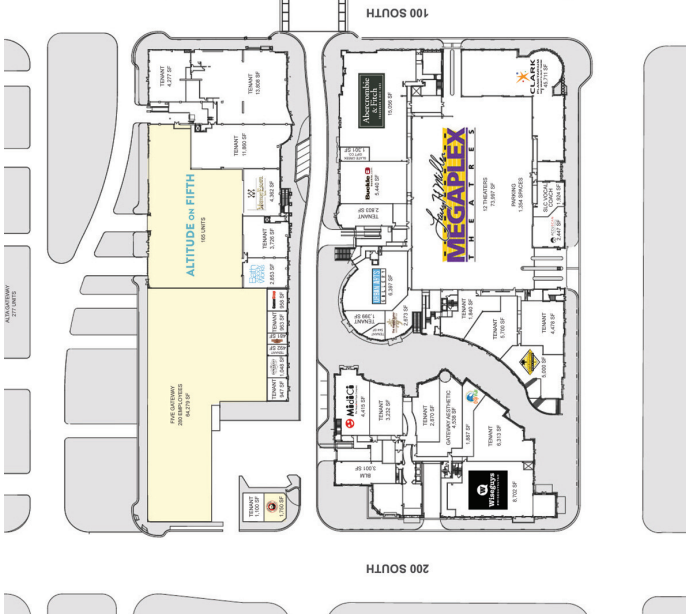
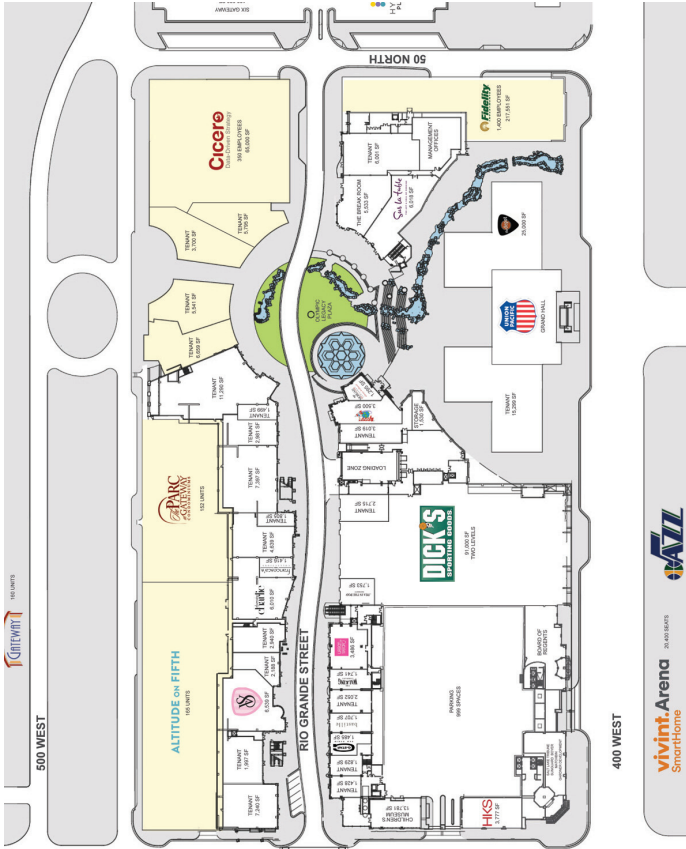

Lower Level

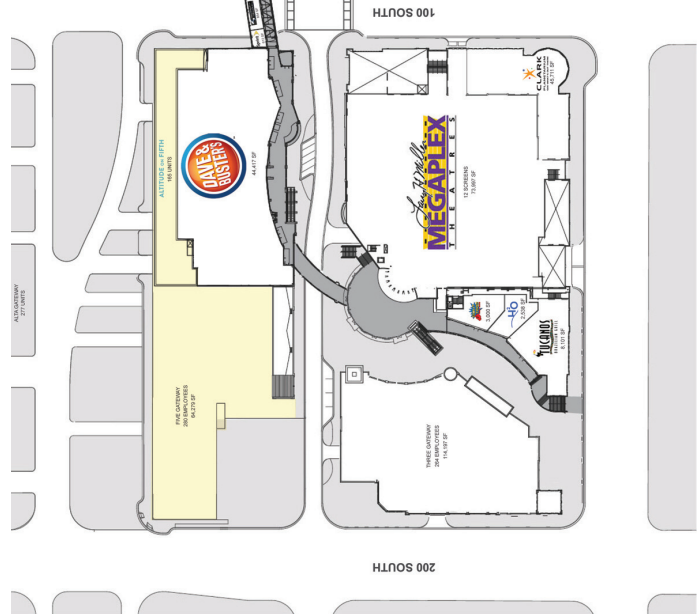

Upper Level

