

BEST IN THE WEST

North Rainbow Boulevard & Lake Mead Boulevard
Las Vegas, Nevada 89108

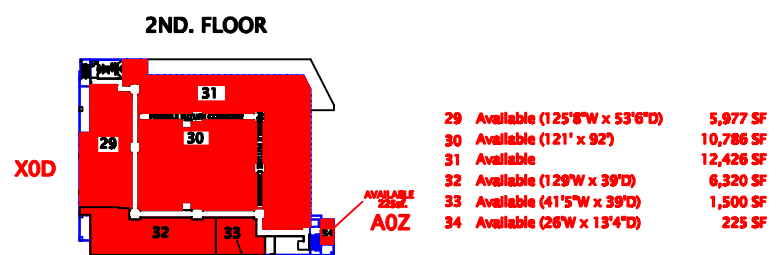
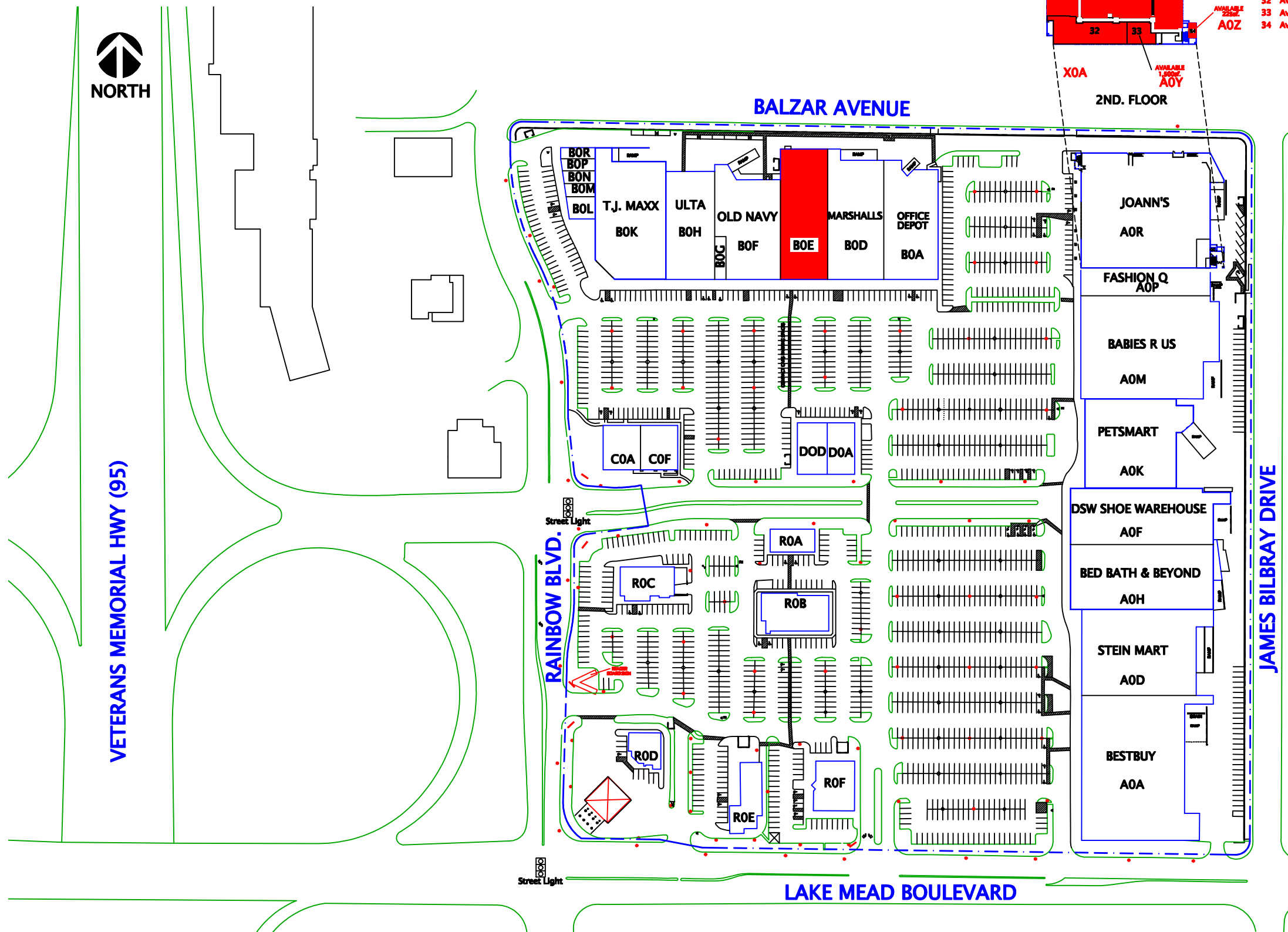

29 Available (125'8"W x 53'6"D)	5,977 SF
30 Available (121' x 92')	10,786 SF
31 Available	12,426 SF
32 Available (129'W x 39'D)	6,320 SF
33 Available (41'5"W x 39'D)	1,500 SF
34 Available (26'W x 13'4"D)	225 SF

SITE SUMMARY

Building Area		428,126 SF
A0A	Best Buy	46,720 SF
A0D	Stein Mart	30,896 SF
A0F	DSW Shoe Warehouse	25,902 SF
A0H	Bed Bath & Beyond	28,377 SF
A0K	PetSmart	26,207 SF
A0M	Babies R Us	39,315 SF
A0P	Fashion Q	11,000 SF
A0R	Joann's	46,140 SF
BOA	Office Depot	18,600 SF
BOD	Marshalls	21,007 SF
BOE	Available (82'7" x 230')	18,993 SF
BOF	Old Navy	19,000 SF
BOG	Diva Beauty	1,500 SF
BOH	Ulta	16,000 SF
BOK	T.J. Maxx	25,000 SF
BOL	Which Wich? Superior Sandwiches	1,128 SF
BOM	Rita's Ice-Custard	1,200 SF
BON	Available (22' x 56')	1,236 SF
BOP	State Farm Insurance	1,231 SF
BOR	Omaha Steaks	1,139 SF
COA	Jared's	5,946 SF
COF	Men's Wearhouse	4,060 SF
DOA	Alfred Angelo Bridal	4,340 SF
DOD	Mattress Firm	4,335 SF
ROA	Sprint	3,128 SF
ROB	Sweet Tomatoes	7,368 SF
ROC	Applebee's	5,227 SF
ROD	Arco	2,850 SF
ROE	McDonald's	4,182 SF
ROF	LoLo's Chicken and Waffles	6,099 SF

Land Area: 1,515,888 sf./ 34.80 Acres
 Building Area: 422,180 sf.
 Parking: 1,841 Spaces @ 4.36 /1000sf.

Scale: 1" = 90'
 Rev.: 05-19-2017

This site plan is presented solely for the purpose of identifying the approximate location and size of the building presently contemplated by the owner. Building sizes, site dimensions, access and parking areas, existing tenant locations and identities are subject to changes without notice and at the owners discretion. Unit numbers as indicated are not necessarily the actual suite numbers and are intended for use as a reference only.